



- Sought After Over 50's Development
- Modern Kitchen With Appliances
- Spacious Lounge Thru To Sun Room
- Downstairs Double Bedroom / Dining Room
- 2 Further Bedrooms and Modern Bathroom
- Jack and Gill Downstairs Shower Room
- Sat In Well Maintained Gardens and Parking
- Leasehold and Active Management Company

The Property and Location

19 Kermode Close is a purpose built property sat within the popular over 50's Ballastowell Gardens Development. Situated within a private and highly accessible location, the surroundings are friendly with a strong community, yet are quiet & peaceful, set within an attractive elevated location; encompassing impressive surrounding views and extensive well maintained gardens.

Vacant possession this purpose built two bedroom home sits in a very pleasant position within this attractive development with Views across the landscaped communal grounds to the wooded hills. The easily managed accommodation briefly comprises: Private Porch Entrance, Lounge, Conservatory, Kitchen, 2 good double bedrooms, one currently used as a dining room. A further single bedroom/study, Family Bathroom upstairs. A Jack and Gill Style Shower Room Downstairs. Gas central heating is installed and the windows are double glazed throughout. There are attractively maintained generous landscaped communal lawned grounds interspersed with footpaths which also lead to the communal residents parking. The property is offered with No Onward Chain! Viewing highly recommended



GROUND FLOOR
682 sq.ft. (63.4 sq.m.) approx.

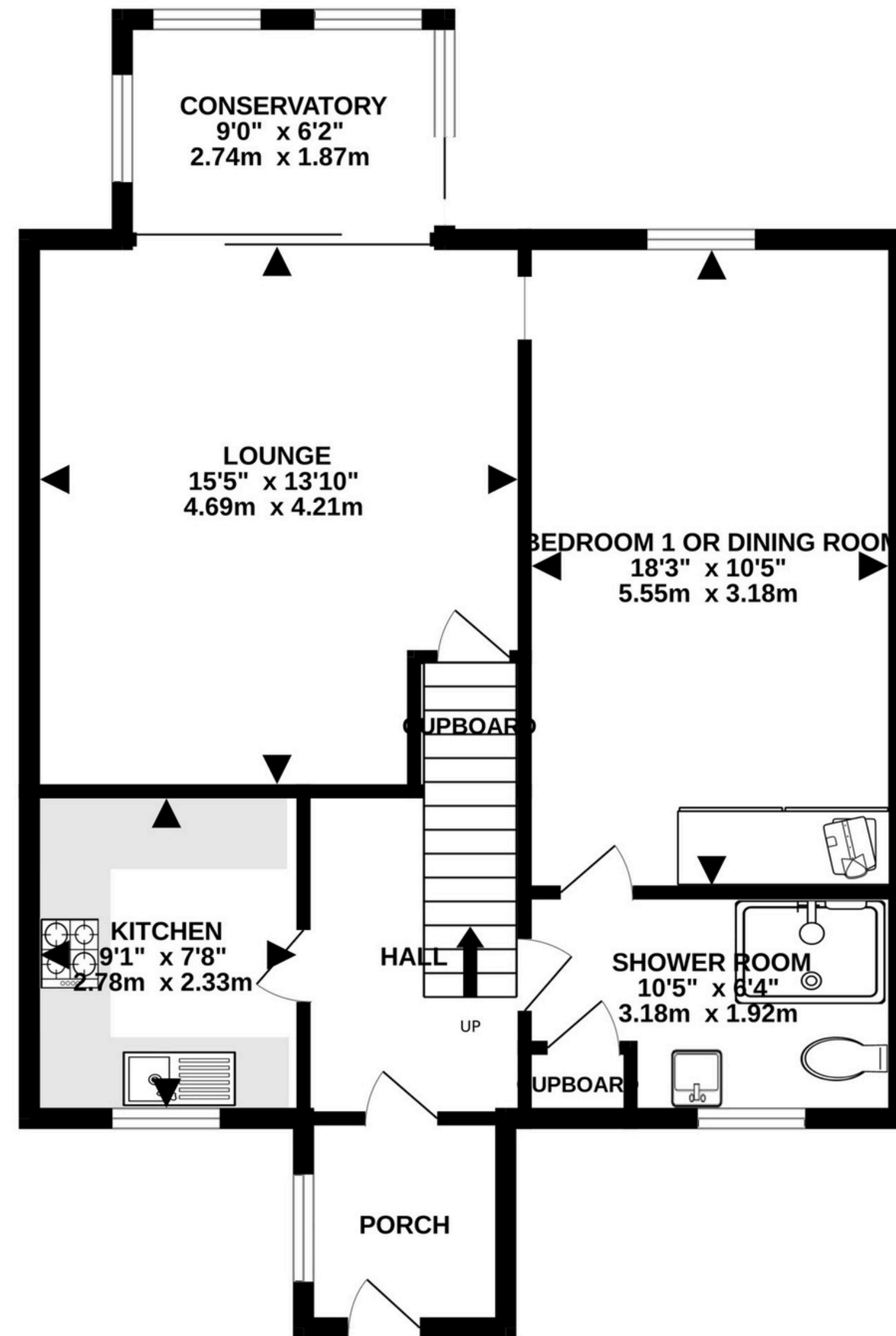

1ST FLOOR
306 sq.ft. (28.5 sq.m.) approx.

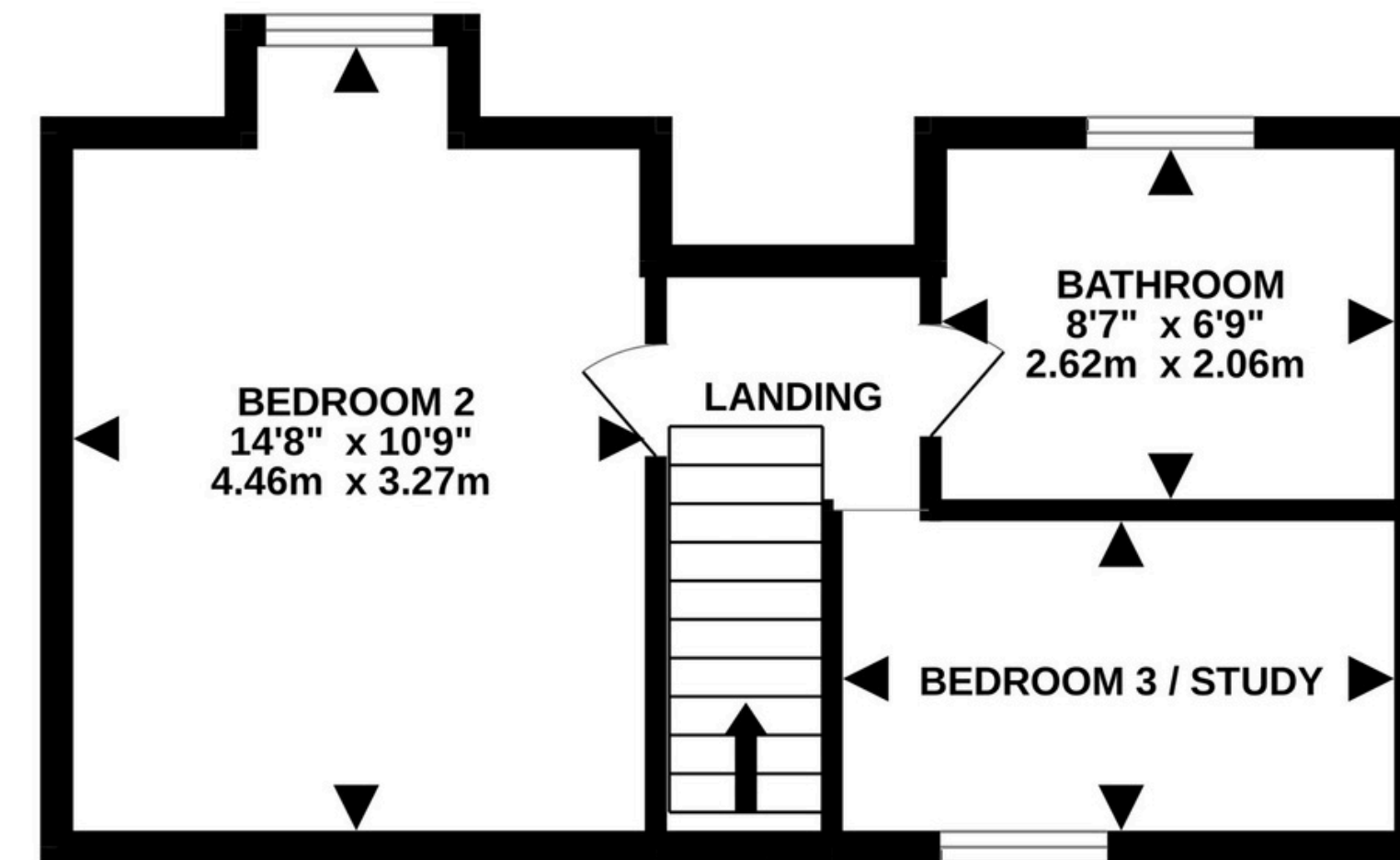

TOTAL FLOOR AREA : 989 sq.ft. (91.8 sq.m.) approx.

Whilst every attempt has been made to ensure the accuracy of the floorplan contained here, measurements of doors, windows, rooms and any other items are approximate and no responsibility is taken for any error, omission or mis-statement. This plan is for illustrative purposes only and should be used as such by any prospective purchaser. The services, systems and appliances shown have not been tested and no guarantee as to their operability or efficiency can be given.
Made with Metropix ©2025

Disclaimer: Whilst all particulars are believed to be correct, neither Property Wise Limited, or their clients guarantee their accuracy nor are they intended to form part of any contract. Floorplans are only for illustrative purposes only, decorative finishes, fixtures, fittings and furnishings do not represent the current state of the property. Measurements are approximate and not to scale.