

**“Eaton Lodge”
Fairfield Avenue
Ramsey, IM8 2LS
£345,000**



Beautifully Presented Victorian Townhouse, Recently Renovated and Finished to a High Standard,
Situating in the Heart of Ramsey Town Centre, Walking Distance to Schools and all Amenities.

Front and Side Gardens, Small Hardstanding for Motor bikes & Bicycles etc.

Accommodation Comprises:-

Set over Three Floors:

Ground Floor: Entrance Porch with Coat Storage,

Spacious Lounge with Large Bay Window and Side Door to Patio & Garden, Contemporary Style
Kitchen with wall and Base Units, Breakfast Bar and all modern Appliances, Cloakroom/WC

First Floor: Landing, Master Bedroom with Large Bay Window and Fitted Wardrobes, Family Bath-
room and Additional Double Bedroom.

Second Floor: Landing & Generous Size Attic Bedroom Room.

Gravelled Front Garden for Low Maintenance and Side Patio Ideal for Entertaining, Hardstanding for
Motobike or Bicycles & outside Storage.

Gas Fired Central Heating and Double glazing Throughout.

“Immaculate Family Property, Ideal location for the TT Enthusiast”

Directions: Travelling from Parliament Square Ramsey towards Sulby on Lezayre Road, take the first turning on the left onto Fairfield Avenue where the property can be found on the right hand side, with Red front door. Easily identified by our 'for sale' board.

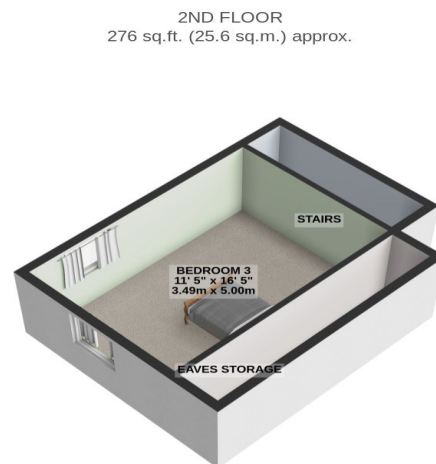
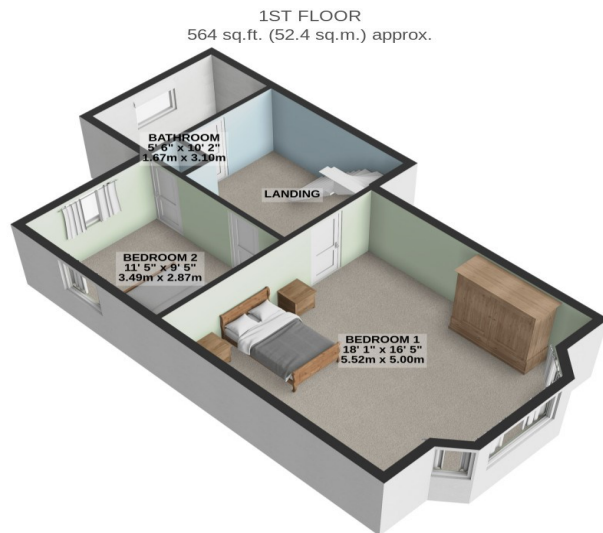
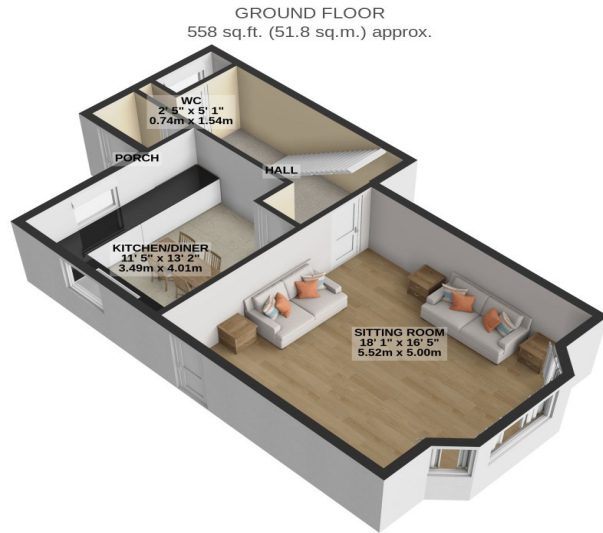

TOTAL FLOOR AREA : 1397 sq.ft. (129.8 sq.m.) approx.

Property Wise Limited, 21 Parliament Street,

Ramsey, Isle of Man, IM8 1AS

Email: Info@propertywise.co.im