

**5 Bradda Place
Maine Road, Port Erin
£425,000**



Modern Town House Situated In The Heart Of Port Erin With The Beach A Stones Throw Away And Fantastic Coastal Walks, Close To All Local Amenities, Shops, Train & Bus Station.

Modern Day Living With A Spacious Open Plan Lounge, Fully Integrated Contemporary Kitchen/Diner With Bif-folding Doors Onto The Decking Area Enjoying Hill Views
Storage/Utility Room, Downstairs WC
4 Good Size Bedrooms, 1 Currently Being Used As A Study
2 Modern Bathrooms With High Quality Ceramic Wall & Floor Tiles
Gas Fired Central Heating, Upvc Double Glazing Throughout
Low Maintenance Garden With A Large Waterproof Storage Area
2 Allocated Parking Spaces To The Rear
10 Year Structural Guarantee (5 Years Remaining)

Directions : Travelling Through Port Erin, Heading Up The Promenade Towards The Golf Course, Take The First Right Hand Turn After Bay View Road Onto Maine Road. The Property Will Be Found A Short Distance Along On The Right Hand Side.

Rates : Please contact the Isle of Man Rates Office on 685661 for Current Rates

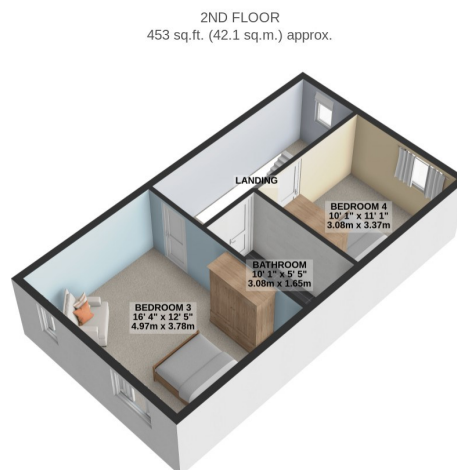
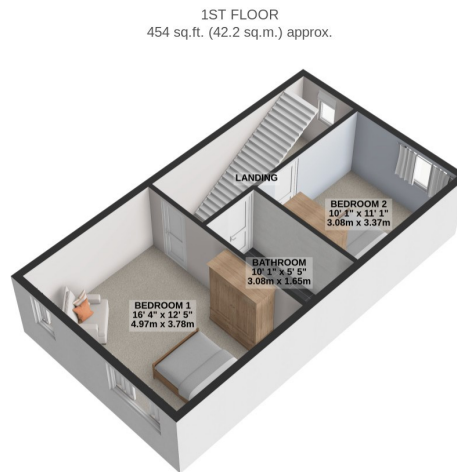
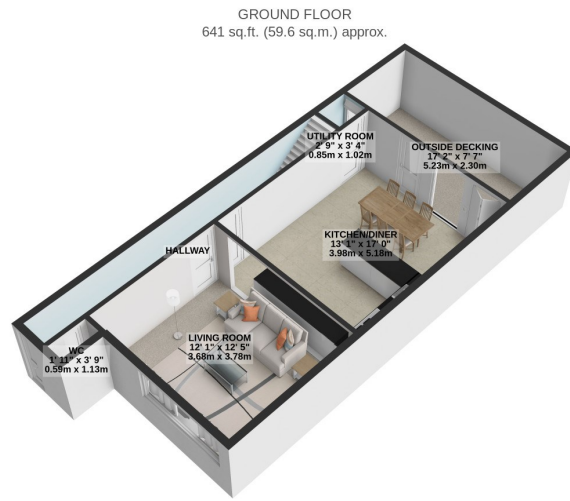
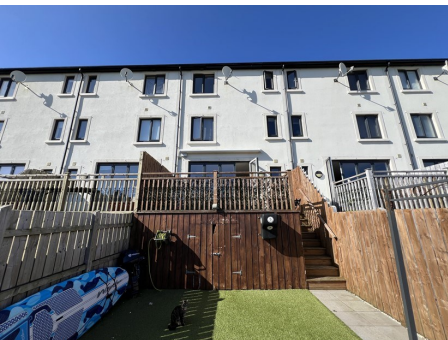

TOTAL FLOOR AREA : 1549 sq.ft. (143.9 sq.m.) approx.

For illustrative purposes only. Decorative finishes, fixtures, fittings and furnishings do not represent the current state of the property. Measurements are approximate. Not to scale.
Made with Metropix © 2024