

38 Auldyn Walk

£255,000



Immaculately Presented Modern 2 Bedroom Mid Terrace House In A Lovely Cul De Sac Location of Auldyn Walk Just A Short Walk To Ramsey Town Centre And All Of Ramseys Schools And Amenities

Accommodation Comprises :-

Entrance Hall
Good Sized Lounge With Understairs Storage and Double Doors Through To
A Spacious Modern Kitchen/Diner With Built In Electric Oven, and Gas Hob
Double Doors Lead Out To An Enclosed Rear Garden That Boasts A Patio Area As Well As Grass
And A Large Well Insulated Built Shed. The Garden Has Double Gates Leading to
2 Numbered And Allocated Off Road Parking Spaces
2 Good Sized Double Bedrooms One With Fitted Wardrobes
Modern Bathroom
Attic Space
Gas Central Heating
Front Garden And Walkway To Front Door
uPVC Throughout

Directions : Travelling from Parliament Square travel out of Ramsey on the Lezayre Road. Just past the school on your right turn right into Gardners Lane. At The bottom Roundabout turn left into Auldyn Walk. Follow the road round to the left and then continue round and number 38 can be found on your right hand side.

Rates : Please contact the Isle of Man Rates Office on 685661 for Current Rates

GROUND FLOOR
331 sq.ft. (30.8 sq.m.) approx.

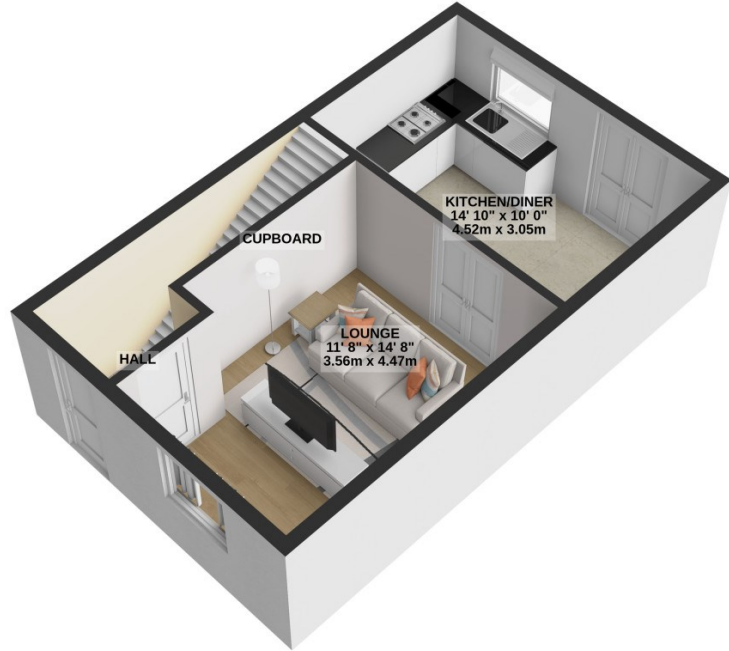

1ST FLOOR
331 sq.ft. (30.8 sq.m.) approx.

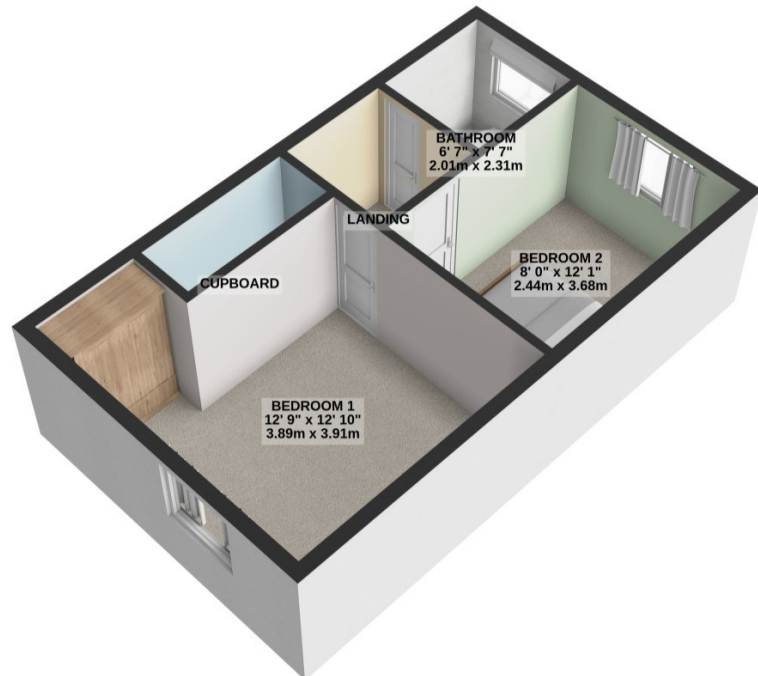

TOTAL FLOOR AREA : 662 sq.ft. (61.5 sq.m.) approx.

For illustrative purposes only. Decorative finishes, fixtures, fittings and furnishings do not represent the current state of the property. Measurements are approximate. Not to scale.
Made with Metropix © 2024