

**Holly Cottage, Governors Road**

**Onchan**

**£369,950**



**An Attractive And Beautifully Presented Fully Renovated Victorian  
Manx Stone 3 Bedroom Cottage Sat In The Heart Of Onchan Village  
Close to Local Schools Shops And Amenities**

**Accommodation Comprises:-**

Entrance Hall Into An Immaculate And Spacious Open Plan Lounge/Dining Area and Kitchen With Large Pantry , Fridge Freezer, Dish Washer, Washing Machine And Dryer,  
Also Boasting Solid Wood Flooring and LED Built In Ceiling Lights  
Double Doors Out To Side Patio and Rear Garden

Separate Storage/Boiler Room

Further Sitting Room

The Master Bedroom Has A Good Sized Walk In Dressing Room

Further 2 Double Bedrooms Both With Fitted Wardrobes

Large Modern Family Bathroom With Separate Shower Cubicle And Stand Alone Bath

Gas Central Heating

Enclosed Private Rear Garden With Gate Access Out To A Storage Garage

Also Accessible By Lane At Rear

Completely Refurbished and Renovated To An Excellent Standard including New Roof In 2017

**\*\*\*\*\* Viewings Highly Recommended \*\*\*\*\***

**Directions:** Travelling north along Douglas Promenade turn left up Summerhill and Holly Cottage can be seen in front of you at the roundabout at the top just before Corkill's Garage.

**Rates payable:** TBA

**Inclusions: to be confirmed**

**Services:** All Major Services



GROUND FLOOR  
565 sq.ft. (52.4 sq.m.) approx.



1ST FLOOR  
558 sq.ft. (51.9 sq.m.) approx.

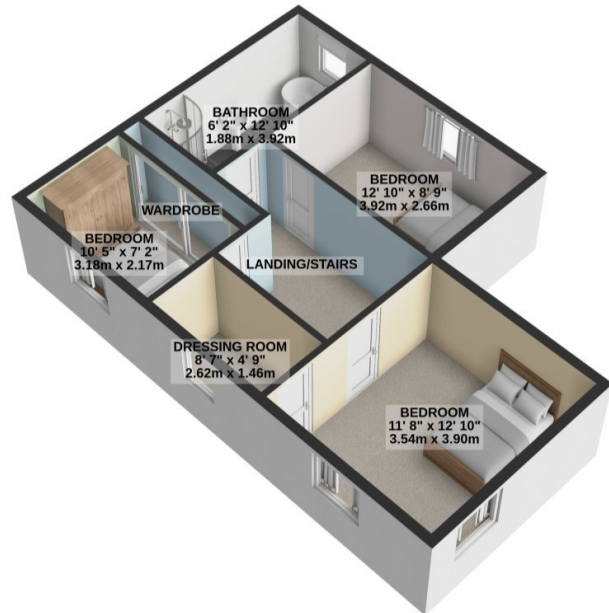

TOTAL FLOOR AREA : 1123 sq.ft. (104.3 sq.m.) approx.

For illustrative purposes only. Decorative finishes, fixtures, fittings and furnishings do not represent the current state of the property. Measurements are approximate. Not to scale.  
Made with Metropix © 2024