

21 Sycamore Grove,
Douglas
£195,000



Spacious Ground Floor Purpose Built 2 Bed Apartment With Your Own Private Entrance, Situated in a Convenient Residential Location Close to Schools, Shops and Amenities

Large Light and Airy Lounge, Fully Fitted Kitchen /Breakfast Room

2 Double Bedrooms 1 With Built In Wardrobes

Modern Family Bathroom Comprising Bath With Shower Above , Sink & W.C

Gas Fired Central Heating, Upvc Double Glazed Throughout

Airing Cupboard, Large Storage Cupboard

Allocated Parking Space And Ample Visitors Parking Available

Outside Storage Cupboard, Outside Paved Communal Area

***** NO ONWARD CHAIN *****

Directions: Travelling from the Quarterbridge towards Douglas along Peel Road turn right at the traffic lights on to Pulrose Road, continue along the road keeping left at the corner with Groves Road, continue along the Road keeping left until you come to an arched entrance on the left hand side for Sycamore Grove where the property can be found on the right hand complex.



GROUND FLOOR
676 sq.ft. (62.8 sq.m.) approx.

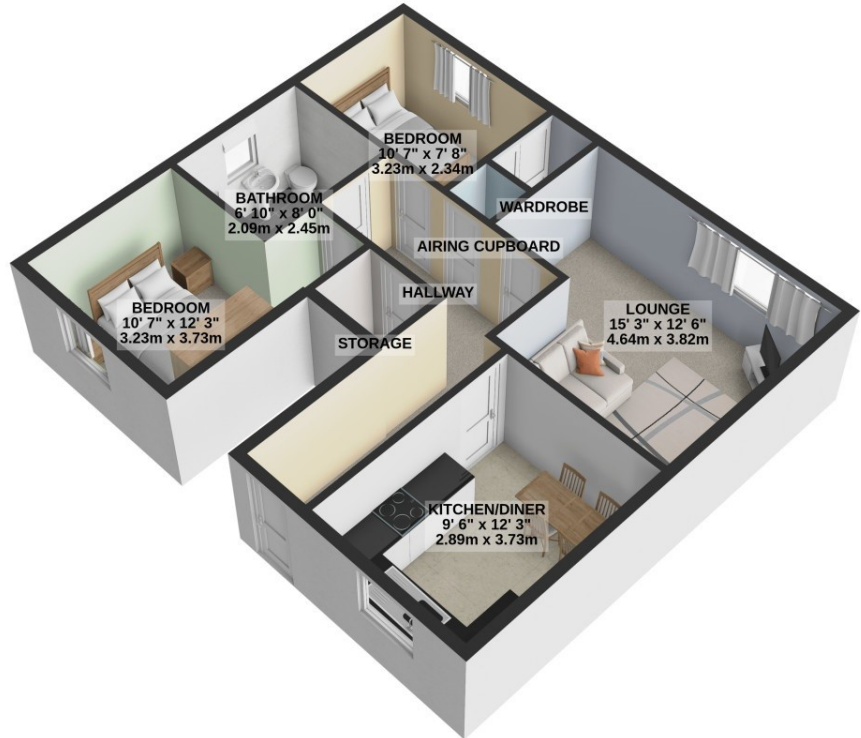

TOTAL FLOOR AREA : 676 sq.ft. (62.8 sq.m.) approx.

For illustrative purposes only. Decorative finishes, fixtures, fittings and furnishings do not represent the current state of the property. Measurements are approximate. Not to scale.
Made with Metropix © 2024