

71 Wybourn Grove, Onchan, IM3 4AT

Asking Price £299,950 (Negotiable)



**Immaculately Presented and Deceptively Spacious Mid Terraced House
Situated in a Popular Residential Location with Elevated Sea Views
Close to Local Schools, Shops, Playground and Other Amenities**

Property Comprises:

Large Living Room

Spacious Modern Dining Kitchen

3 Double Bedrooms

Modern Family Bathroom

Extremely Generous Rear Garden

Parking for 2 Cars

Gas Fired Central Heating

uPVC Double Glazing

Viewing's Highly Recommended

Directions : Travelling out of Douglas up Victoria Road, Turn Right at Mini Roundabout and immediately Straight on at 2nd Roundabout, Continue Along Governors Road Towards Onchan, Take the First Right after 1/2 Mile in to Wybourn Drive. Follow to top and right hand bend then take Right Hand Turning in to Wybourn Grove Where number 71 can be easily Located by our For Sale Board.

Whilst all particulars are believed to be correct, neither Property Wise Limited, or their clients guarantee their accuracy nor are they intended to form part of any contract. Floorplans are only for illustrative purposes, decorative finishes, fixtures, fittings and furnishings do not represent the current state of the property. Measurements are approximate and not to scale.



GROUND FLOOR
495 sq.ft. (46.0 sq.m.) approx.



1ST FLOOR
468 sq.ft. (43.5 sq.m.) approx.

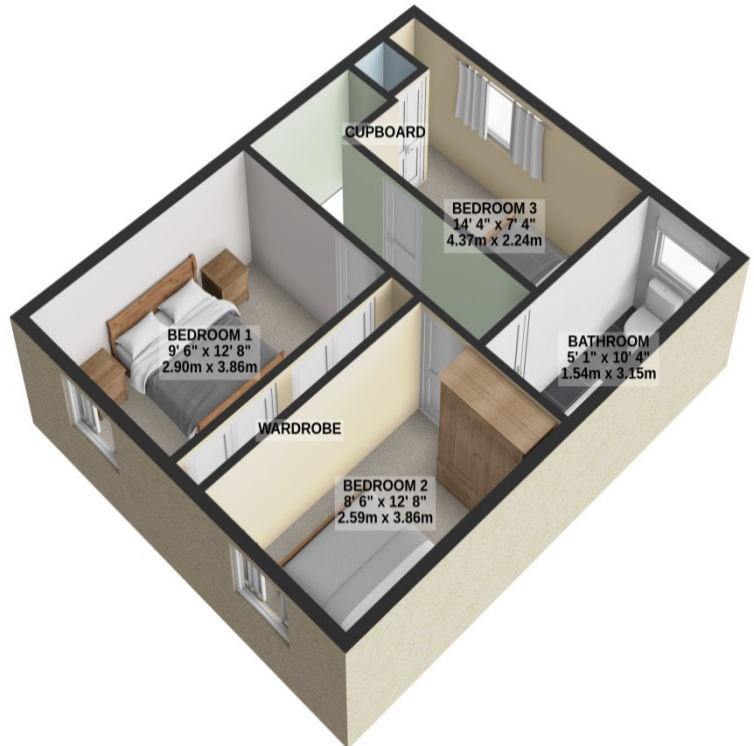

TOTAL FLOOR AREA : 963 sq.ft. (89.4 sq.m.) approx.

For illustrative purposes only. Decorative finishes, fixtures, fittings and furnishings do not represent the current state of the property. Measurements are approximate. Not to scale.
Made with Metropix © 2024