

60 Wybourn Drive, Onchan, IM3 4AT

Asking Price £389,950



**Detached Chalet Bungalow Situated in a Popular Residential Location**

**Close to Local Schools, Shops and Amenities**

**The Property is Well Presented Throughout**

**Spacious Lounge/Dining Room**

**Fitted Modern Kitchen**

**3 Double Bedrooms**

**Modern Family Bathroom**

**Single Garage and Off Road Parking for 3 / 4 Cars**

**Large Private Rear Garden with Sun Deck and Shed**

**uPVC Double Glazing**

**Oil Central Heating**

**Viewing's Highly Recommended**

**Directions** : Travelling out of Douglas up Victoria Road, Turn Right at Mini Roundabout and immediately Straight on at 2nd Roundabout, Continue Along Governors Road Towards Onchan, Take the First Right after 1/2 Mile in to Wybourn Drive. Follow to top and right hand bend Where number 60 can be easily Located by our For Sale Board.



GROUND FLOOR  
860 sq.ft. (79.9 sq.m.) approx.

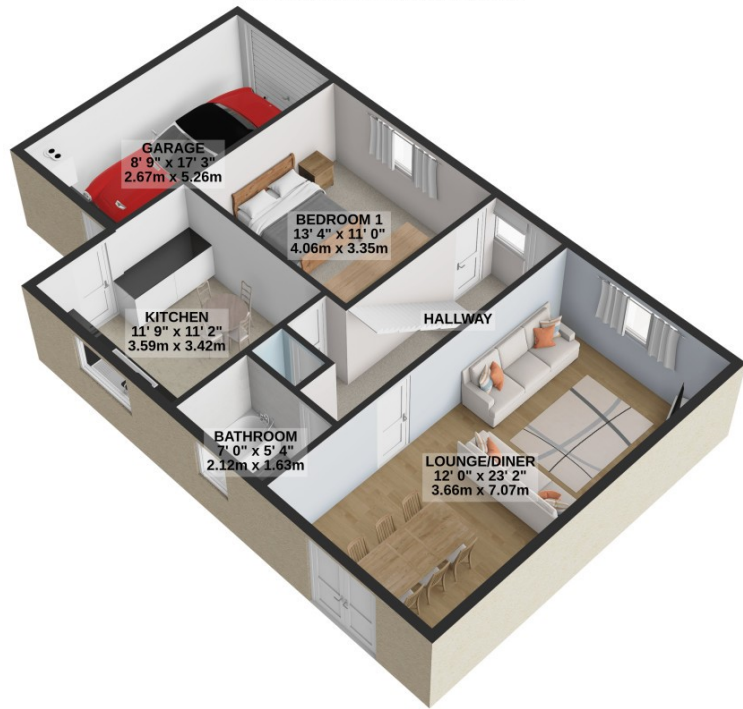

1ST FLOOR  
607 sq.ft. (56.4 sq.m.) approx.

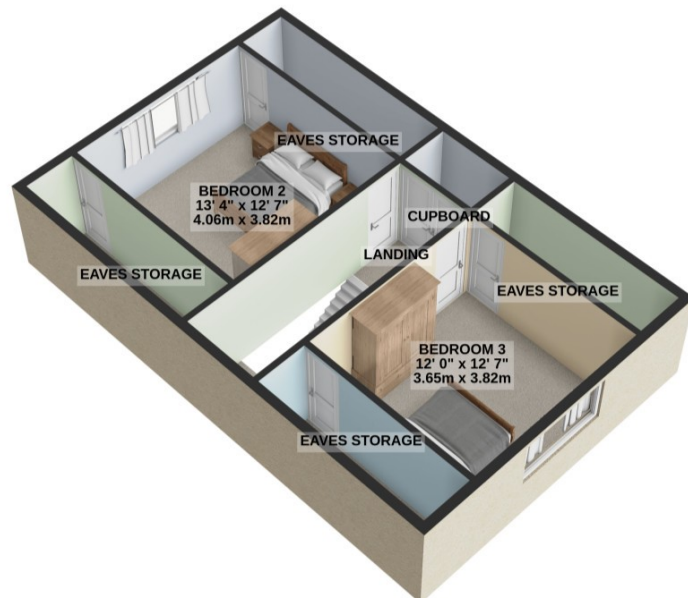

TOTAL FLOOR AREA : 1466 sq.ft. (136.2 sq.m.) approx.

For illustrative purposes only. Decorative finishes, fixtures, fittings and furnishings do not represent the current state of the property. Measurements are approximate. Not to scale. Made with Metropix © 2024