

**3 Lime Street
Port St Mary IM9 5ED**



**Delightful Manx Stone 3 Bedroom Cottage Situated In The Heart Of Port St Mary With
Stunning Sea And Harbour Views
Close To Local Amenities With Stunning Coastal Walks On Your Doorstep**

Entrance Porch With Door Leading Into Lounge, Opening Through To Dining/Kitchen With
Door Leading To Sun Room And WC

Open Staircase From Lounge Leading To Bedroom 1 With Sliding Fitted Wardrobes
Bedroom 2 With A Built In Wardrobe, Fully Tiled Family Bathroom Comprising Shower,
Wash Hand Basin & WC

Open Staircase Leading To Top Floor Bedroom With Ample Storage.

New Fitted Approx 3 Years Ago Upvc Everest Double Glazing
Efficient Electric Heating

Beautiful Enclosed Walled Matrue Garden, With Storage Shed.

General Parking Available To The Rear On The Harbourside.

The Property Would Benefit From Modernsiation

NO ONWARD CHAIN

Directions:- Travelling From The Four Roads Roundabout Into Port St Mary Through The Main
Shopping Street Leading Onto Park Road, Take The Second Left Into Queens Road. Continue
To The Bottom Of The Road, Turn Left Then Left Again Onto Lime Street Where Number 3 Can
Be Found On The Right Hand Side Clearly Identified By Our For Sale Sign.



GROUND FLOOR
391 sq.ft. (36.3 sq.m.) approx.

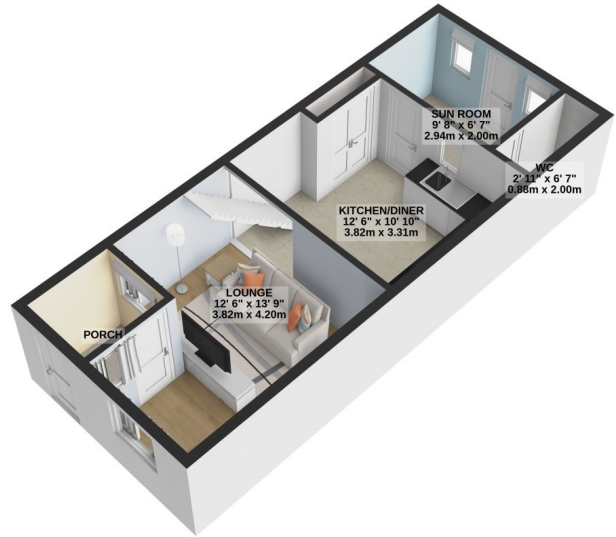

1ST FLOOR
257 sq.ft. (23.9 sq.m.) approx.

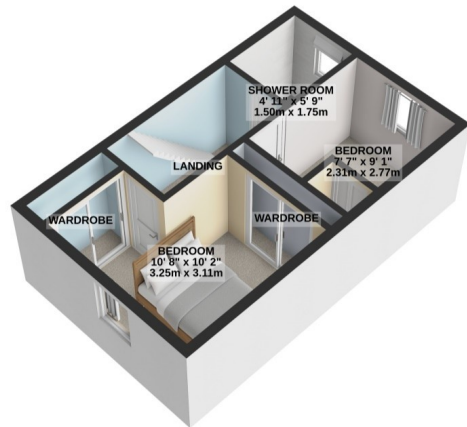

2ND FLOOR
212 sq.ft. (19.7 sq.m.) approx.

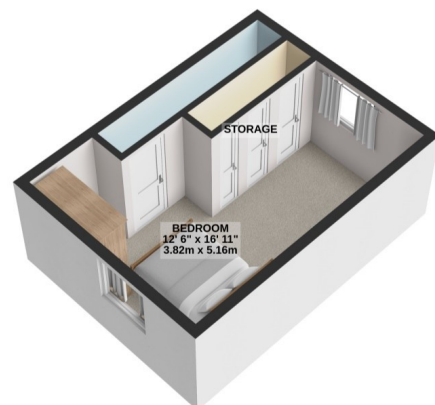

TOTAL FLOOR AREA : 860 sq.ft. (79.9 sq.m.) approx.

For illustrative purposes only. Decorative finishes, fixtures, fittings and furnishings do not represent the current state of the property. Measurements are approximate. Not to scale. Made with Metropix © 2024