



**16 Champion Way, Abbeyfields
Douglas**

£1500 PCM Inclusive Of Rates



**Well Presented Modern Semi Detached House
Situated In A Much Sought After Location
Close to Local Schools, Shops and Amenities
Lounge**

Kitchen / Dining Room

3 Bedrooms

Modern Family Shower Room and Downstairs Cloakroom

Good Sized Private Sunny Rear Garden

Single Integral Garage

Driveway Parking for 2 Cars

Gas Fired Central Heating

UPVC Double Glazed Throughout

Directions: Travelling out of Douglas from Villa Marina, proceed up Broadway and onto Ballaquayle Road then straight through the traffic lights onto Ballanard Road, Turn right at mini roundabout and head along Johnny Wattersons Lane and take the last right into Champion Way. Proceed down the road where the property can be found a Short Distance on the Right Hand Side

Rent £1500 pcm

Deposit £1500 pcm

No Smokers, No Pets, Children Welcome



GROUND FLOOR
556 sq.ft. (51.7 sq.m.) approx.



1ST FLOOR
414 sq.ft. (38.5 sq.m.) approx.

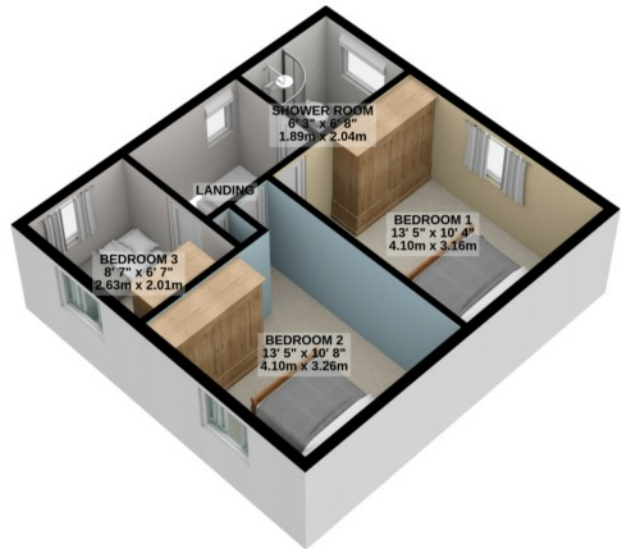

TOTAL FLOOR AREA : 970 sq.ft. (90.1 sq.m.) approx.

For illustrative purposes only. Decorative finishes, fixtures, fittings and furnishings do not represent the current state of the property. Measurements are approximate. Not to scale.
Made with Metropix © 2022

Whilst all particulars are believed to be correct, neither Property Wise Limited, or their clients guarantee their accuracy nor are they intended to form part of any contract. Floorplans are for illustrative purposes only, decorative finishes, fixtures, fittings and furnishings do not represent the current state of the property. Measurements are approximate and not to scale.