



**Ingleside  
15 Derby Road  
Peel  
£295,000**



**4 Bedroom Spacious Family Home Sat In The Heart of Peel  
Walking Distance To All Schools, Town Centre And  
All Local Amenities**

Accommodation Comprises:-

2 Lovely Light, Good Sized Family Rooms

Further Snug/Dining Room

Kitchen

2 Spacious Double Bedrooms and 2 Further Double Bedrooms (Sea Views From The Rear Bedrooms)

Modern Shower Room

Separate WC

Garage

Patio Gardens To The Front and Rear

Off Road Parking

Modernisation is Required Throughout And Particularly In Respect Of The Heating and Water System

**NO ONWARD CHAIN**

Directions : Travelling Into Peel From Douglas Turn Right At The Crossroads Onto Albany Road Just past the QE11 High School On Your Right. At The End Of The Road Turn Right On To Derby Road and Ingleside is Approx 20 Yards Up On Your Left.

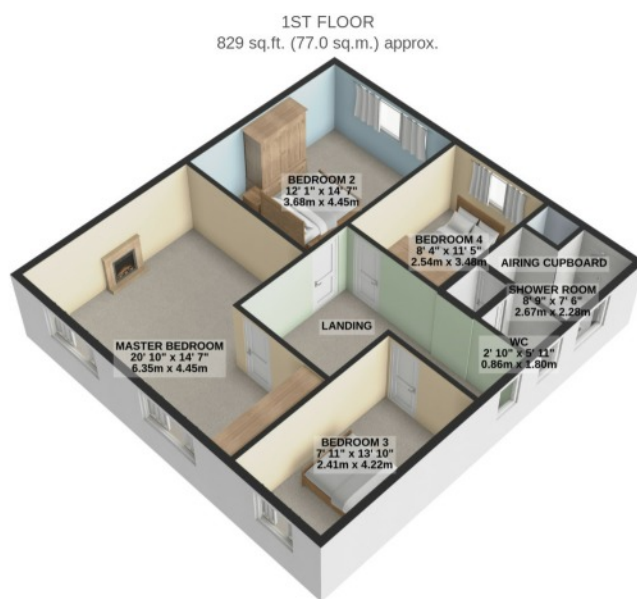
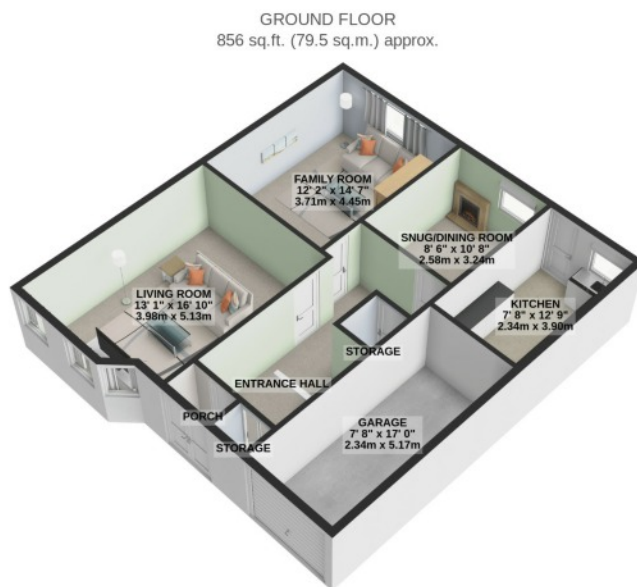

TOTAL FLOOR AREA : 1684 sq.ft. (156.5 sq.m.) approx.

For illustrative purposes only. Decorative finishes, fixtures, fittings and furnishings do not represent the current state of the property. Measurements are approximate. Not to scale.  
Made with Metropix © 2024

Whilst all particulars are believed to be correct, neither Property Wise Limited, or their clients guarantee their accuracy nor are they intended to form part of any contract. Floorplans are for illustrative purposes only, decorative finishes, fixtures, fittings and furnishings do not represent the current state of the property. Measurements are approximate and not to scale.