



**3 Marlborough Crescent
Ramsey, IM8 3NE
£424,950**



**Detached True Bungalow on a Large Corner Plot
Situated in a Sought After Location, close to Ramsey Town Centre.
The Bungalow Benefits from some Updating over the past 7 years.**

Accommodation Comprises:-

Porch, Entrance Hall with Airing Cupboard and Cloaks Cupboard,
Large Lounge with Bow Window,
Refurbished Fitted Kitchen in 2017 with Neff Double Oven and Hob,
Family Bathroom Renovated in 2015,
Separate Utility Room Leading to Integral Garage and Rear Garden,
Shower Room (in need of upgrading),

Three Double Bedrooms, Conservatory with New Roof 2016 Leading to Rear Garden,
Beautiful Rear Garden laid to Lawn with Fencing, Mature Hedging and
Established Flower Beds & Shrubs, Greenhouse.

The Garden extends to the Side and Front.

Oil Fired Central Heating with new Double Bunded Tank 2017.

Upvc Double Glazed Throughout,
Electrical Review and Work Completed 2016.

New Electric Garage Door 2016

'No Onward Chain'

Directions: From the traffic lights in Parliament Square, drive north along Bowring Road and continue to the top of the hill. Travel past the Grove Museum then take the next left into Thornhill Park. Follow the road to the right, then take the 3rd turning on the right into Marlborough Way, then right again onto Marlborough Crescent and the property can be found on the left hand side.

Inclusions: to be discussed Services: All Mains Services Connected Total Rates: £869.97



GROUND FLOOR
1385 sq.ft. (128.6 sq.m.) approx.

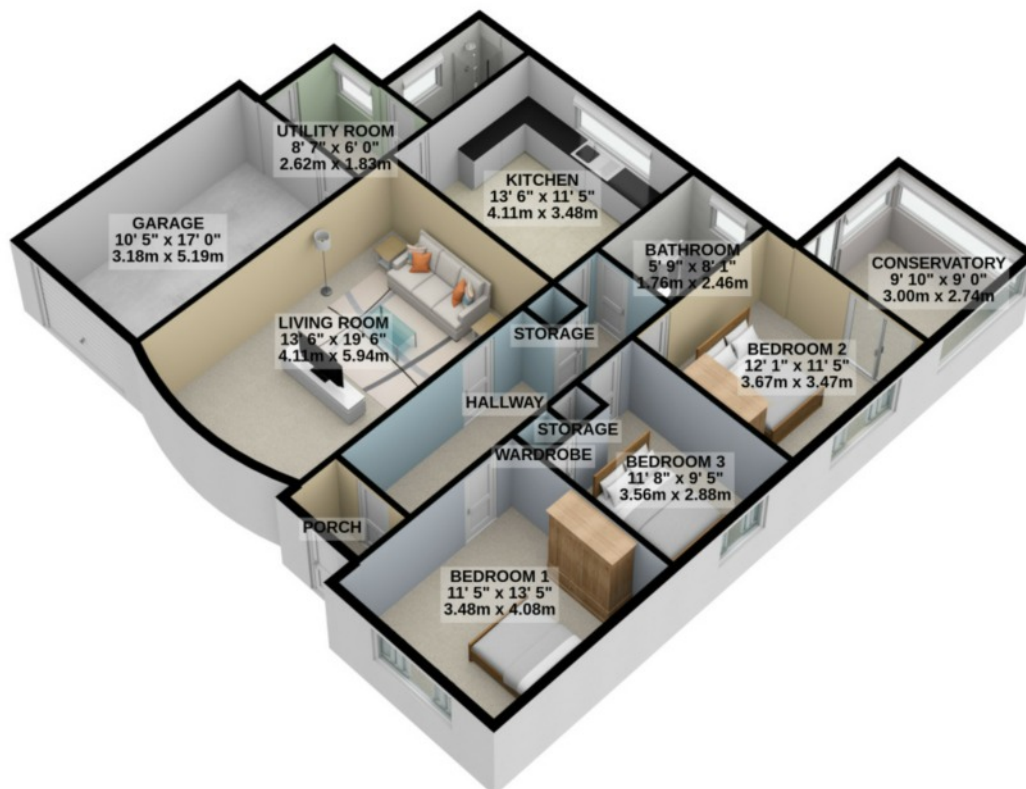

TOTAL FLOOR AREA: 1385 sq.ft. (128.6 sq.m.) approx.



Whilst all particulars are believed to be correct, neither Property Wise Limited, or their clients guarantee their accuracy nor are they intended to form part of any contract. Floorplans are for illustrative purposes only, decorative finishes, fixtures, fittings and furnishings do not represent the current state of the property. Measurements are approximate and not to scale.