

21 Elm Drive

Peel

£245,000



**A Spacious Well Presented 2 Bed Mid Terrace House
Situated in a Sought After Location Within Walking Distance
To The Schools, Swimming Pool and Shops**

Entrance Opens Into Hallway Leading
to a Spacious Lounge With Under Stairs Storage

Modern Open Plan Kitchen/Diner with Electric Oven and Hob
1 Good Size Double Bedroom

A Further Double Bedroom

Modern Family Bathroom

Easily Maintained Rear Garden

Gas Fired Central Heating - New Boiler 2022

uPVC Double Glazing Throughout

Ideal Investment or First Time Buyer Home

Directions: Travelling Out Of Peel Along Derby Road, Passed Shopright, School and Pool Continue to The Second Roundabout Take a left At The Highway Man onto Oak road, Follow The Road All the Way round take a left Onto Hawthorn drive then Right Into Elm Drive The Property Can Be Located on The Right Hand side

Rates payable: TBA

Inclusions: to be confirmed

Services: Mains Water, gas and Electric Services Connected



GROUND FLOOR
319 sq.ft. (29.7 sq.m.) approx.

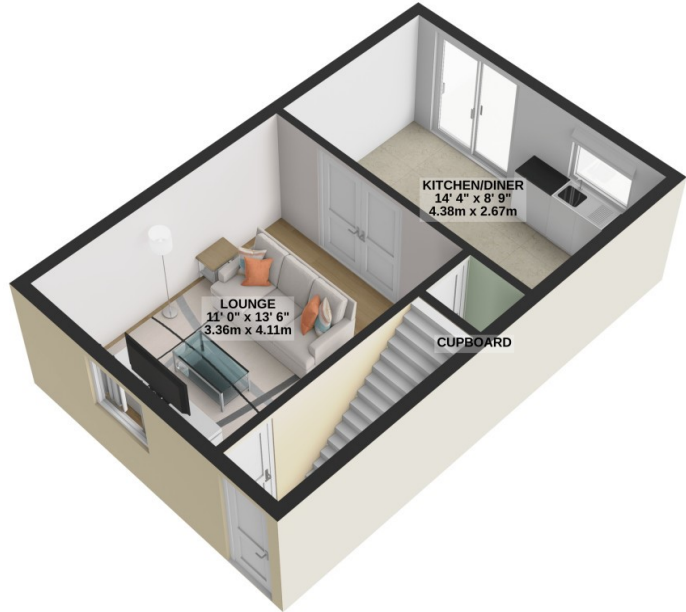

1ST FLOOR
319 sq.ft. (29.7 sq.m.) approx.

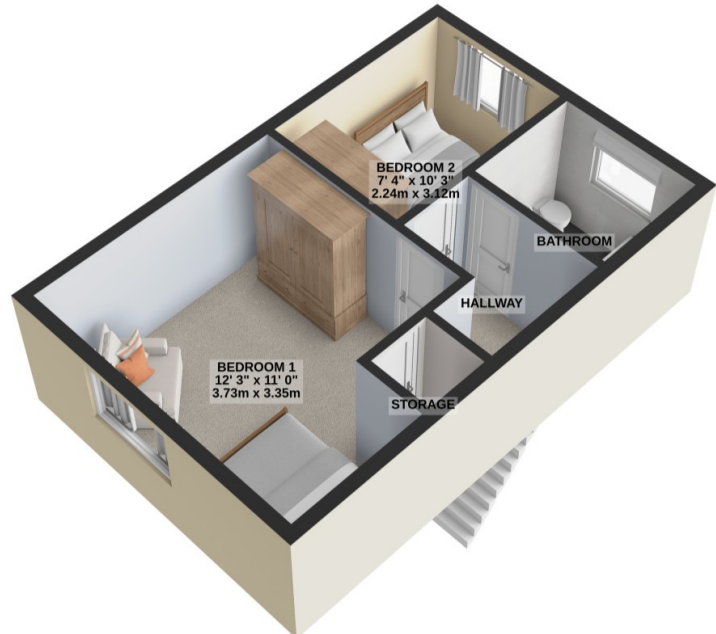

TOTAL FLOOR AREA : 639 sq.ft. (59.3 sq.m.) approx.

For illustrative purposes only. Decorative finishes, fixtures, fittings and furnishings do not represent the current state of the property. Measurements are approximate. Not to scale. Made with Metropix © 2024