



**30 Royal Park
Ramsey
£685,000**



**Immaculately Presented Executive Detached 5 Bedroom House
With High Quality Fixtures and Fittings Throughout
Two Minute Walk to Mooragh Lake/Park and Ramsey Promenade**

Accommodation Comprises:

Spacious Entrance Hall, Cloakroom WC
Large Lounge with Double Doors To Rear Garden
Separate Family Room
Open Plan Fitted Family Kitchen, Dining Room
With Double Doors Through To A Small Sun Room
Utility Room Through to Extensive Double Garage
Spacious Master Bedroom with En-Suite and Dressing Room
Good Sized Double Bedroom Suite With Dressing Room and En-Suite
Further 3 Double Bedrooms Spacious Modern Family Bathroom,
uPVC Double Glazing, Gas Central Heating
Off Road Parking For 3 Cars

****Viewings Highly Recommended****

Directions: From Ramsey travel north along Bowring Road and after the bridge turn right into North Shore Road. Continue along to the Promenade and turn left. Travel along the Promenade and follow the road round to the left and up the hill. The entrance to Royal Park can be found on the left hand side. When you reach the properties bear left where the property will be on your right hand side.

Rateable Value £ TBA **Rates Payable** TBA

Tenure: Freehold



TOTAL FLOOR AREA : 2743 sq.ft. (254.8 sq.m.) approx.

For illustrative purposes only. Decorative finishes, fixtures, fittings and furnishings do not represent the current state of the property. Measurements are approximate. Not to scale. Made with Metropix © 2023

1ST FLOOR
1319 sq.ft. (122.6 sq.m.) approx.

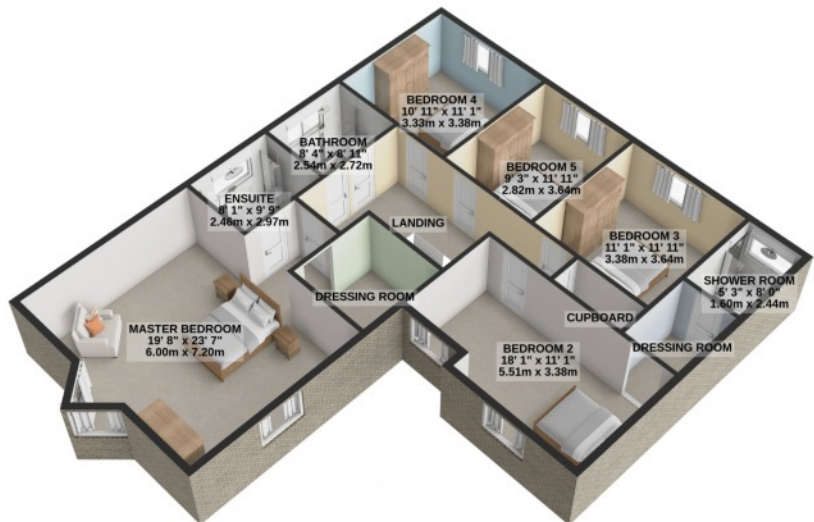

TOTAL FLOOR AREA : 2743 sq.ft. (254.8 sq.m.) approx.

For illustrative purposes only. Decorative finishes, fixtures, fittings and furnishings do not represent the current state of the property. Measurements are approximate. Not to scale. Made with Metropix © 2023