

**8 Albany Road
Peel
£310,000**



**Spacious 3 Bedroom Detached Period House
Sat In The Heart of Peel Close to The Schools
Shops and Local Bus Routes**

The Accommodation Comprises:-
Entrance Porch Into The Hallway
Lounge To The Front With Laminate Flooring and Feature Electric Fire
Dining Room/Further Reception Room With Doors Out To Rear Enclosed Garden
Light Kitchen With Plenty of Storage and Rear Door To Garden
2 Double Bedroom and 1 Single Bedroom
Family Shower Room
Separate WC
Further Large Attic Room For Storage
Oil Fired Central Heating
Off Road Parking
Garage

This Property is Sold As Seen And Is Need of Some Remedial Works And Modernisation

NO ONWARD CHAIN

Directions : Driving In to Peel On The Douglas Road turn Right At The Cross Roads On To Albany Road. No 8 Can Be Found On The Left Just Before The Manse Clearly Marked By Our For Sale Board.

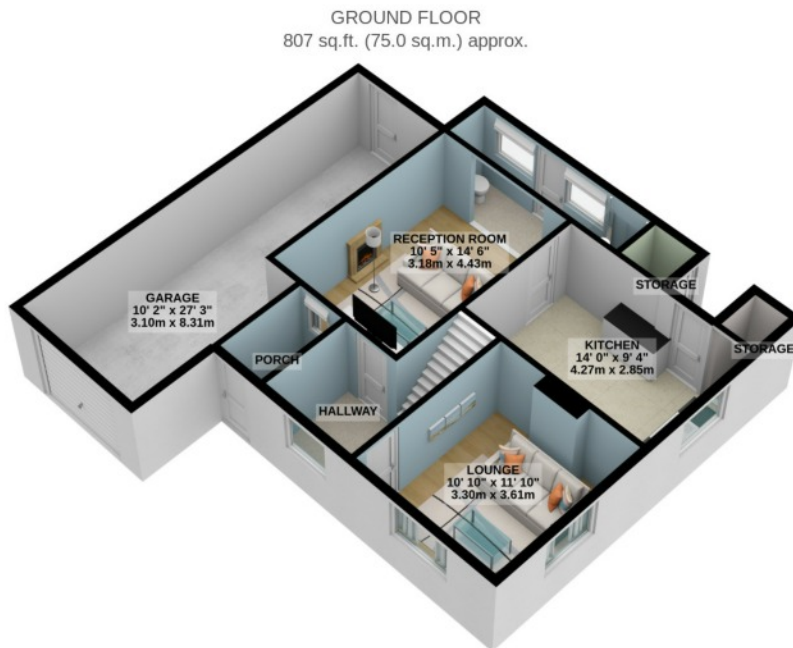

1ST FLOOR
541 sq.ft. (50.3 sq.m.) approx.



TOTAL FLOOR AREA : 1348 sq.ft. (125.2 sq.m.) approx.

For illustrative purposes only. Decorative finishes, fixtures, fittings and furnishings do not represent the current state of the property. Measurements are approximate. Not to scale. Made with Metropix © 2023

Whilst all particulars are believed to be correct, neither Property Wise Limited, or their clients guarantee their accuracy nor are they intended to form part of any contract. Floorplans are for illustrative purposes only, decorative finishes, fixtures, fittings and furnishings do not represent the current state of the property. Measurements are approximate and not to scale.