



42 AULDYN MEADOW DRIVE
£299,950



A Well Presented Modern 3 Bed Terraced Town House
Sat In The Sought After Auldyn Meadow Location
Just A Short Walk To Ramsey And All The Local Schools And Amenities

The Accommodation Offers

Entrance Hall With Washroom Into A Modern Open Plan Modern Kitchen/Dining Living Area With Double Doors Out To A Well Maintained Private Rear Garden

Kitchen has Built In AEG Oven Hob and Microwave, Fridge Freezer and Dishwasher

The First Floor has 2 Good Sized Double Bedrooms (1 With Fitted Wardrobes) And A Modern Family Bathroom

The Master Bedroom Sits On The Top Floor With a Separate Shower Room

A Large Storage Cupboard And Plenty of Eaves Storage

Gas Fired Central Heating

2 Allocated Parking Spaces

Viewing Highly Recommended

Directions: Travelling out of Ramsey via Lezayre Road, turning right into Gardeners Lane, opposite Milntown. Continue down the road and at the roundabout turn right and then take the first on the right onto Auldyn Meadow Drive, number 42 can be located on the left hand side as you follow the drive round

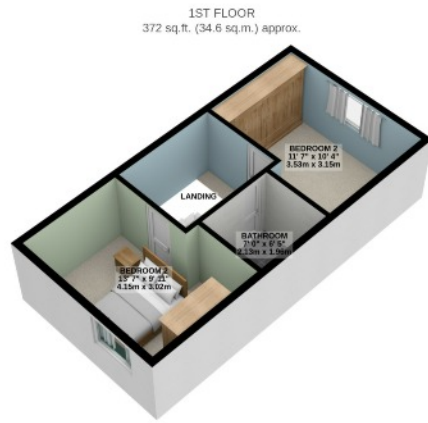
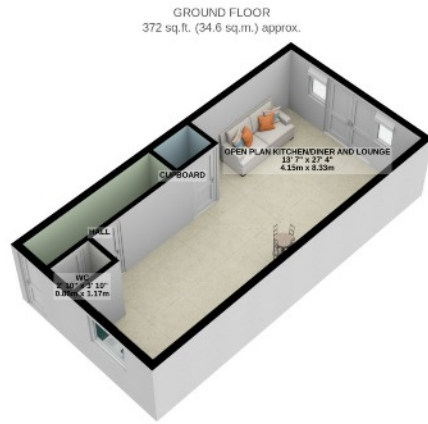

TOTAL FLOOR AREA: 1015 sq.ft. (94.3 sq.m.) approx.

For illustrative purposes only. Decorative finishes, fixtures, fittings and furnishings do not represent the current state of the property. Measurements are approximate. Not to scale. Made with Metropix © 2023

Whilst all particulars are believed to be correct, neither Property Wise Limited, or their clients guarantee their accuracy nor are they intended to form part of any contract. Floorplans are for illustrative purposes only, decorative finishes, fixtures, fittings and furnishings do not represent the current state of the property. Measurements are approximate and not to scale.