



**Beachway
Balleira Road, Kirk Michael
£299,995**



**2 Bed Detached True Bungalow Sat In ½ Acre of Gardens
Overlooking The Sea, Just a Short Walk to the Beach and also to
the Shops and School**

Good Sized Bungalow In an Idyllic Location But In Need Of
Refurbishment throughout.

The Property Currently Comprises:-

2 Double Bedrooms

Bathroom

Large Kitchen

Separate Utility

Dual Aspect Lounge with Open Fire Place

Front Port Area

Off Road Parking

**Cash Buyers Only
Ideal Project For An Experienced Builder**

Directions: Heading on the Main Road Through Kirk Michael Coming From Peel, Drive Through The Village, Past The Local Shops and After Seeing Christian Avenue On Your Left, Balleira Road is The Next Turning On Your Left Towards Kirk Michael Beach and Kirk Michael Football Club. Follow The Road Down, Immediately You Drive Under The Old Iron Railway Bridge, There Is a Narrow Turning On your Left. At the Top of This, Beachway Is The First Bungalow on Your Right.



GROUND FLOOR
872 sq.ft. (81.0 sq.m.) approx.

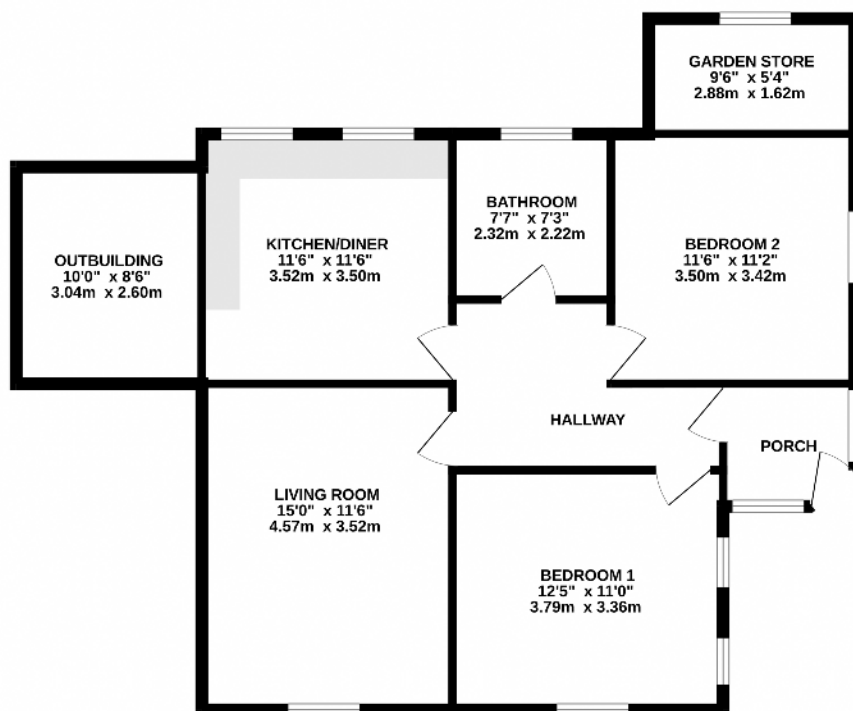

TOTAL FLOOR AREA: 872 sq.ft. (81.0 sq.m.) approx.
While every attempt has been made to ensure the accuracy of the floorplan contained here, repeat measures of floors, walls, doors and other areas are required and are to be taken by a suitably qualified person or measurement. This plan is for illustrative purposes only and should be used as such by any prospective purchaser. The purchaser should always check the actual condition and the guarantee as to their capability or efficiency can be given.
 Know with Intention ©2008

Whilst all particulars are believed to be correct, neither Property Wise Limited, or their clients guarantee their accuracy nor are they intended to form part of any contract. Floorplans are for illustrative purposes only, decorative finishes, fixtures, fittings and furnishings do not represent the current state of the property. Measurements are approximate and not to scale.