

4 Royal Terrace, Onchan**Asking Price £459,950**

Spacious Modern Mid Terraced Town House

Totally Renovated and Refurbished Over the Past Few Years

Situated in a Much Sought Location Offering Delightful Sea Views from Most Rooms

Bright and Airy Throughout

Large Lounge With Feature Fireplace

Modern Open Dining Kitchen

Family Room with Wood Burner and Bi-Fold Doors Leading Rear Garden

Whole Ground Floor Benefits from Fitted High Quality Moduleo Flooring

Master Bedroom with Outstanding Sea Views (With En-suite Shower Room and Walk in Wardrobe)

Further 4 Double Bedrooms with 2 Additional Bathrooms Study / Home Office

Modern Double Glazed Sliding Sash Windows Throughout

Gas Fired Central Heating (Recently Fitted with a Atag Combi Boiler)

Large Front Lawned Garden Rear Patio Terrace Garden

Driveway Parking for 2 Cars (Planning Permission Granted for Garage with no Expiry Date - Partly Constructed).

Viewings Highly Recommended

Directions: Travelling along Douglas Promenade towards Onchan, follow the road past the old Summerland building then turn left over the tram lines at Port Jack, onto Royal Terrace, follow the road along and No 4 can be found a short way up on the left hand side.



GROUND FLOOR
723 sq.ft. (67.1 sq.m.) approx.

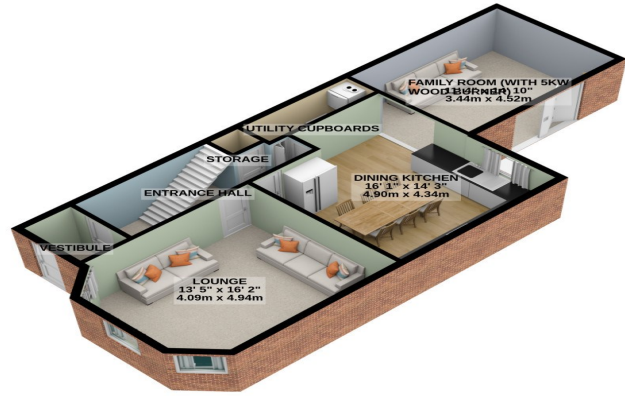

1ST FLOOR
585 sq.ft. (54.3 sq.m.) approx.

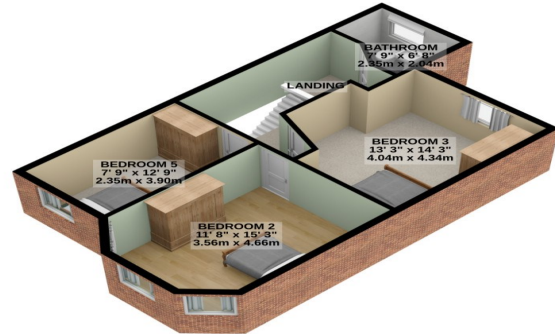

2ND FLOOR
575 sq.ft. (53.4 sq.m.) approx.

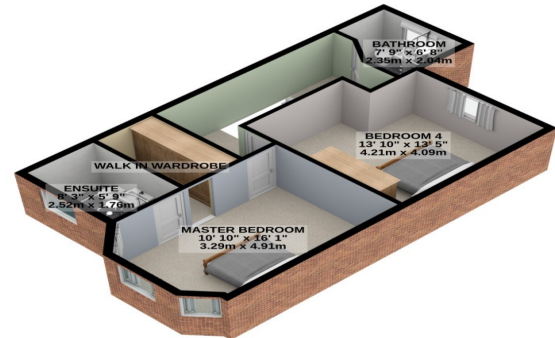

3RD FLOOR
104 sq.ft. (9.7 sq.m.) approx.

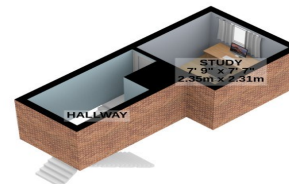

TOTAL FLOOR AREA : 1986 sq.ft. (184.5 sq.m.) approx.

For illustrative purposes only. Decorative finishes, fixtures, fittings and furnishings do not represent the current state of the property. Measurements are approximate. Not to scale. Made with Metropix © 2023

Property Wise Limited, First Floor, St. Georges Chambers,
1 Athol Street, Douglas, Isle of Man, IM1 1LD

Email: Info@propertywise.co.im