

**Glendale  
Douglas Road  
Kirk Michael**

**£450,000**



**Detached Four Bed Bungalow Situated in Large Plot of  
Approx. One Third of an Acre and Located in Popular Village,  
Close to Primary School.**

**Accommodation Comprises:**

**Dual Aspect Lounge, Kitchen Diner, Utility Room, Two Double  
Bedrooms and Family Bathroom.**

**Upstairs, One Double Bedroom and One Single Bedroom  
with Separate W.C.**

**Double Garage, Parking for Multiple Vehicles.**

**LPG Central Heating, uPVC Windows**

**Directions:** proceed from Parliament Square south along Lezayre Road. Continue through Kirk Michael and after passing the school and left hand bend the property can be found a little further on on the right.

**Rates Payable: £1,192.34**(Inc. Water Rates)

**Tenure: Freehold**

**Services:** Mains Water, gas and Electric Services Connected



**GROUND FLOOR**  
1182 sq.ft. (109.8 sq.m.) approx.

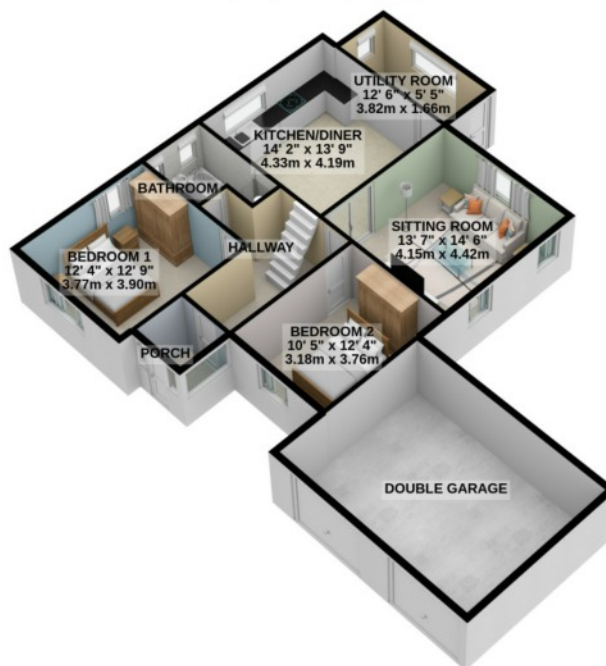

**1ST FLOOR**  
352 sq.ft. (32.7 sq.m.) approx.



**TOTAL FLOOR AREA : 1534 sq.ft. (142.5 sq.m.) approx.**

For illustrative purposes only. Decorative finishes, fixtures, fittings and furnishings do not represent the current state of the property. Measurements are approximate. Not to scale.  
Made with Metropix © 2022

Whilst all particulars are believed to be correct, neither Property Wise Limited, or their clients guarantee their accuracy nor are they intended to form part of any contract. Floorplans are for illustrative purposes only, decorative finishes, fixtures, fittings and furnishings do not represent the current state of the property. Measurements are approximate and not to scale.