

24 Church Avenue, Onchan

Asking Price £299,000



Charming Double Fronted End Terrace House
Situated in a Popular and Convenient Area of Onchan Within Walking Distance To
Shops, Primary School, Local GP Surgery, Bus Routes and Park
The Property has Benefited From Complete Updating and Modernisation to an
Exacting Quality Standard, Including New Roof

Property Comprises of:-

Lovely Light and Airy Lounge With Feature Wood Log Fireplace

3 Bedrooms (2 Double and 1 Single)

Stunning Modern Family Bathroom Comprising of a 4 Piece Suite Including A Generous Shower and Bath With a Chrome Towel Rail Radiator

Beautiful Newly Fitted Modern Kitchen With Integrated Oven, Hob, Dishwasher and Washer Dryer

Large Dining Room with Electric Fire

Separate Snug/Study

The House Has Had a New Roof Fitted and Includes Kingspan Insulation

All New Carpets And Floor Coverings Throughout The House

Low Maintenance Rear Back Garden Area With Potential to Enhance

Patio Area With a Large Shed Which Has Power

Small South Facing Front Garden

Viewing's Highly Recommended

Directions: Travelling North through Onchan Village, Proceed through both sets of traffic lights taking the first left into Church Avenue. Continue towards the top of the road, where No 22 can be found on the Right hand side clearly identified by our For Sale Board.

Inclusions: All Flooring and Light Fittings. **Rateable Value:** £ TBA **Rates Payable:** £ TBA (Inc. Water Rates)



GROUND FLOOR
428 sq.ft. (39.7 sq.m.) approx.

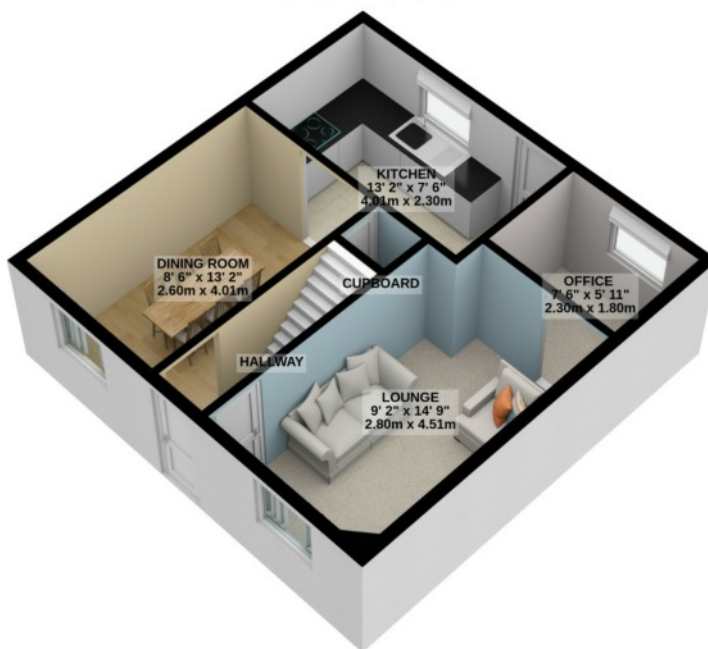

1ST FLOOR
428 sq.ft. (39.7 sq.m.) approx.

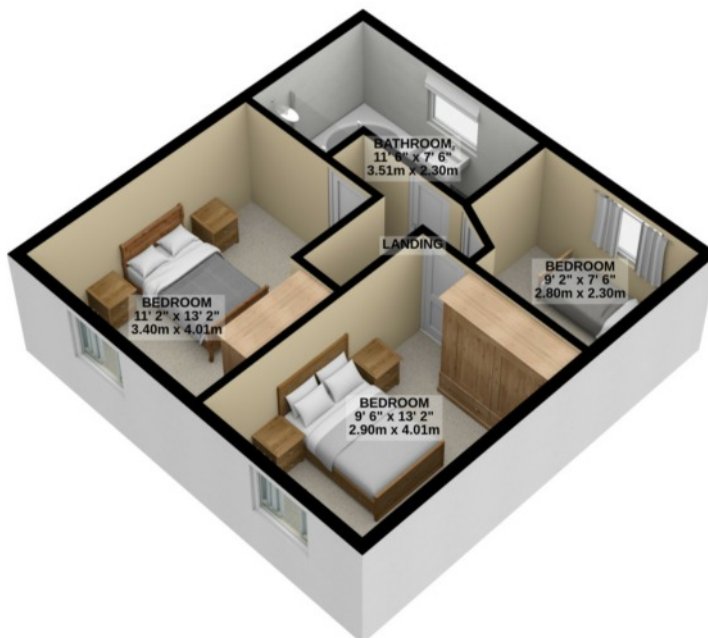

TOTAL FLOOR AREA : 856 sq.ft. (79.5 sq.m.) approx.

For illustrative purposes only. Decorative finishes, fixtures, fittings and furnishings do not represent the current state of the property. Measurements are approximate. Not to scale.
Made with Metropix © 2022