



**14 Isle of Alanis
Mooragh Promenade
Ramsey**

£189,950



Spacious Two Bedroom Apartment with Fantastic Sea Views, situated on the Second Floor.

The Property Benefits from a Large Communal Garden.

Active Management Company within the Building.

Accommodation Comprises:

Entrance Hall, Large Lounge with Bay Window,

Modern Fitted Kitchen/Diner,

Two Good Size Double Bedrooms, Family Bathroom,

Gas Central Heating,

uPVC Double Glazing Throughout,

Lawned Communal Garden with Boundary Hedging.

‘Ideal Holiday Home or Investment Property’

Directions: proceed from Parliament Square north over the bridge and take right turn into North Shore Road. At the end of the road turn right and the block can be found a little way along on the right, clearly identified by our For Sale sign

Rates Payable: £968.55 (Inc. Water Rates)

Management Fees: £120 per month Tenure: Leasehold

Services: Mains Water, gas and Electric Services Connected



GROUND FLOOR
795 sq.ft. (73.9 sq.m.) approx.

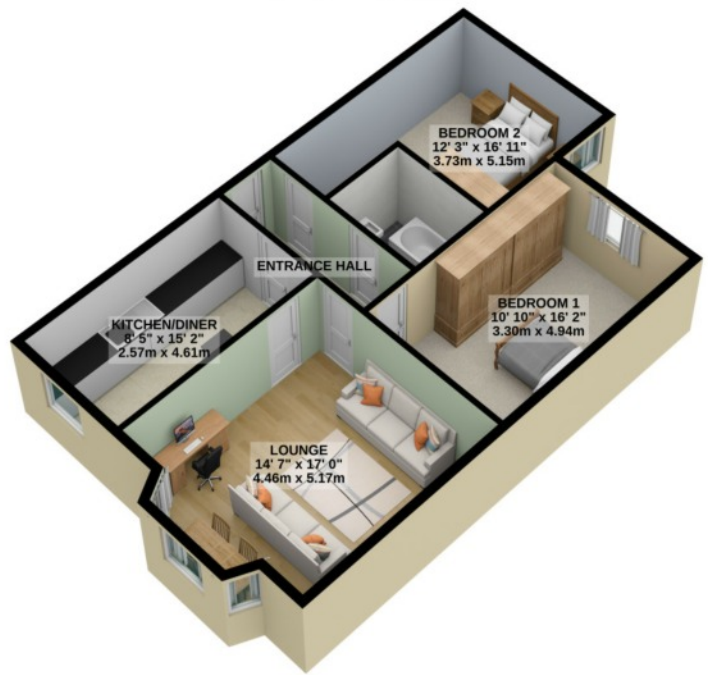

TOTAL FLOOR AREA : 795 sq.ft. (73.9 sq.m.) approx.

For illustrative purposes only. Decorative finishes, fixtures, fittings and furnishings do not represent the current state of the property. Measurements are approximate. Not to scale.
Made with Metropix © 2022

Whilst all particulars are believed to be correct, neither Property Wise Limited, or their clients guarantee their accuracy nor are they intended to form part of any contract. Floorplans are for illustrative purposes only, decorative finishes, fixtures, fittings and furnishings do not represent the current state of the property. Measurements are approximate and not to scale.