



## 5 Westminster Terrace Douglas

Asking Price £350,000



A stunning 5 bedroom terraced property located in walking distance to the centre of Douglas having been modernised to an extremely high standard.

The property is divided over 3 floors with family in mind or for discerning Individuals who wish to entertain. The property has been refurbished to keep its original character but yet offers contemporary open plan living,

Briefly the property comprises of

Ground floor, Large Open Plan Lounge Diner/2<sup>nd</sup> Reception Area  
Family Breakfast kitchen, Separate Utility Room

1st floor, 3 principal bedrooms, Luxury bathroom, Shower Room

2<sup>nd</sup> floor, 2 further bedrooms and Modern Family Bathroom.

GFCH, uPVC

Detached Garage

“Viewing’s Highly Recommended!”

**Directions:** Travelling out of Douglas from the Quarterbridge Roundabout turn onto Quarterbridge Road, continue up the road and take the second turning on the right onto Alexander Drive, proceed to the end of the road and turn left onto Westminster Drive where No 5 can be seen on the right hand side clearly identified by our For Sale board.

Rateable Value£

Rates £

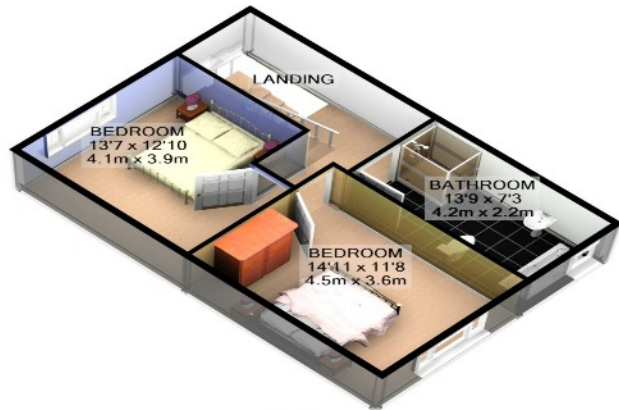

2ND FLOOR  
APPROX. FLOOR  
AREA 538 SQ.FT.  
(50.0 SQ.M.)

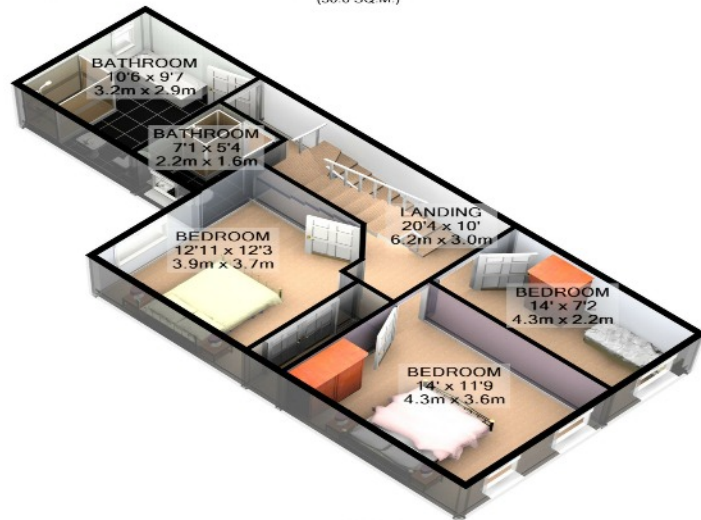

1ST FLOOR  
APPROX. FLOOR  
AREA 706 SQ.FT.  
(65.6 SQ.M.)



GROUND FLOOR  
APPROX. FLOOR  
AREA 960 SQ.FT.  
(89.2 SQ.M.)

TOTAL APPROX. FLOOR AREA 2204 SQ.FT. (204.8 SQ.M.)

For illustrative purposes only. Decorative finishes, fixtures, fittings and furnishings do not represent the current state of the property. Measurements are approximate. Not to scale. Made with Metropix ©2016