



**19 Factory Lane
Peel
£260,000**



**A Spacious 3 Bed Mid Terrace Town House In The Heart of Peel
Located Conveniently To Shops, Bus Stops, and the Beach**

Porch Into Lounge with Electric Fire Place and Beamed Ceiling
Large Open Plan Kitchen/Diner with Electric Oven and Hob, Laminate
Floor

Downstairs Bathroom

Double Bedroom with Built in Cupboards to The Front

Double Bedroom With Built In Storage to The Rear

Shower Room

Double Attic Bedroom Built in Storage

Outside Boasts Small Yard Area Leading up to A Stunning Large
Hidden Garden with Views out To Peel Castle, The Sea and Harbour
With Garden Room/Shed

Double Glazed Wooden Sash Windows and Gas Fired Central Heating

No Onward Chain

Directions: ravelling Into Peel Passed the QE2 High School, At the Junction Turn Right Onto Albany Road, Then Left Down onto Derby Road, Drive down Factory Lane Alongside Shamy Hey Tea rooms. Park on the Prom and walk back up to The Property

Inclusions: to be confirmed

Services: All Mains Services Connected

Rates Payable:£TBC

Rateable Value:£TBC



GROUND FLOOR
466 sq.ft. (43.3 sq.m.) approx.

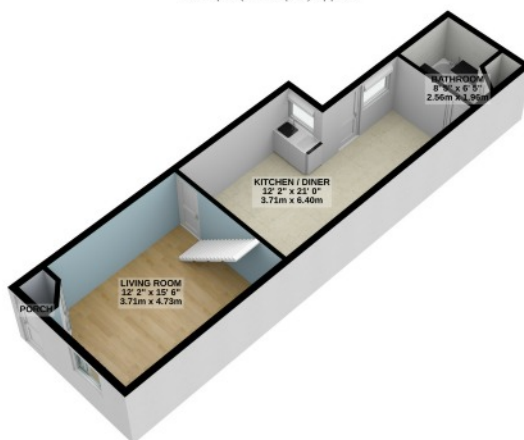

1ST FLOOR
340 sq.ft. (31.6 sq.m.) approx.

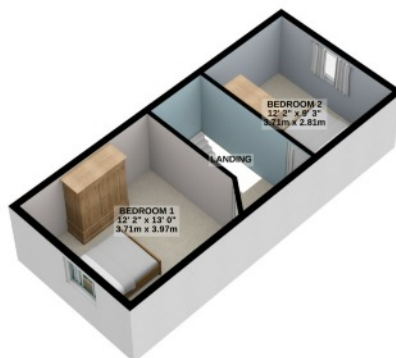

2ND FLOOR
252 sq.ft. (23.4 sq.m.) approx.

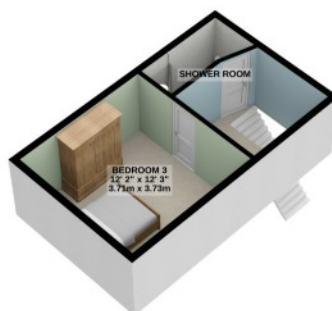

TOTAL FLOOR AREA : 1058 sq.ft. (98.3 sq.m.) approx.

For illustrative purposes only. Decorative finishes, fixtures, fittings and furnishings do not represent the current state of the property. Measurements are approximate. Not to scale.
Made with Metropix © 2021

Whilst all particulars are believed to be correct, neither Property Wise Limited, or their clients guarantee their accuracy nor are they intended to form part of any contract. Floorplans are for illustrative purposes only, decorative finishes, fixtures, fittings and furnishings do not represent the current state of the property. Measurements are approximate and not to scale.